

# Membrane Housing Specification Chart

WAVE - P - 8 -     -  -  -

Membrane Housing Paint Color Options:

WH	White
BL	Blue

Length Code  
See Attachment 1 for options

Permeate Port Options:

H	Socket Union Adaptor,PVC,32mm O.D. Pipe
J	Socket Union Adaptor,PVC,1.32" O.D. Pipe
V	Mechanical Coupling 1"-ABS
S	Mechanical Coupling 1"-SS
F	Female Thread NPT 1"
G	Female Thread Rp 1"
M	Male Thread NPT 1 1/4"
N	Male Thread NPT 1 1/2"
UF	Mechanical Coupling 1.5"
W	Sanitary Connection 1"
K	Sanitary Connection 1.5"

Feed/Concentrate Port Configurations  
See Feed/Concentrate Port Chart for options and code information

Membrane Housing Diameter: 8"

Feed/Concentrate Port Type: Side Port

Membrane Housing Max. Operating Pressure Options:

150	150PSI
300	300PSI
450	450PSI
600	600PSI
1000	1000PSI
1200	1200PSI

Brand Name

### Attachment 1: Membrane Housing Length Options

F (Dash)	1	1.5	2	3	4	5	6	7	7.5	8
Code	1	1.5	2	3	4	5	6	7	7.5	8

### Attachment 2: Side Port Size

	1.5"	2"	2.5"	3"
150PSI	✓	✓	✓	✓
300PSI	✓	✓	✓	✓
450PSI	✓	✓	✓	✓
600PSI	✓	✓	✓	✓
1000PSI	✓	✓	✓	✓
1200PSI	✓	✓	✓	✓

Standard Model: WAVE-300P-8-1R2R-H-6-WH—8", 300PSI, Dash 6, Two 1.5" Side Port Orientation-0°, Permeate Port Thread- G 1 1/2"X 11 Male Thread, White Paint

Ordering:

Membrane Model: \_\_\_\_\_

Model: \_\_\_\_\_

Contact Person: \_\_\_\_\_

Quantity: \_\_\_\_\_

Contact: \_\_\_\_\_

# FEED/CONCENTRATE PORT CHART

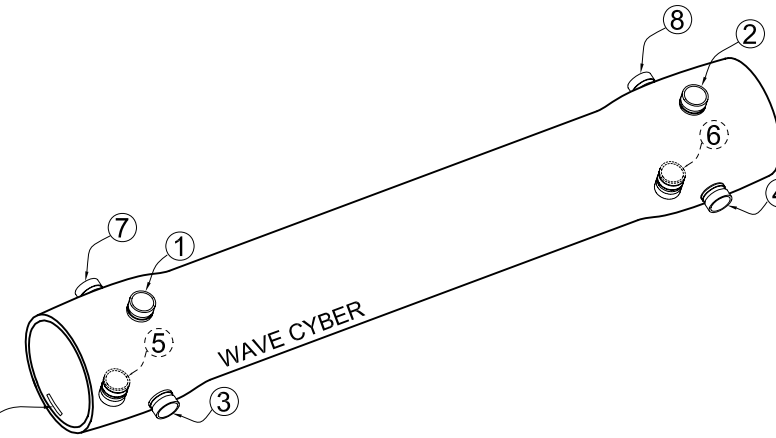

Serial No.

This chart is used to specify the location of the ports for each different vessel configuration in the system. Always use this chart to specify proper side port locations. If you have any questions, call the factory. Please use this chart as follows:

- Determine proper port sizes on multiple port vessels.
- Determine the proper port location and quantity for each vessel.
- Starting at the serial number end, enter the location of the first port followed by the port size. Repeat this for each port on the serial number end.
- Moving to the opposite end, enter the location of the first port followed by the port size. Repeat this for each port on this end.
- Enter this information at the bottom of the ordering page for each vessel configuration.
- Sign and date the ordering page before you send it to us.

Port Size Code	
R	1-1/2" Mechanical Coupling
S	2" Mechanical Coupling
T	2-1/2" Mechanical Coupling
U	3" Mechanical Coupling

Note: Three ports per end maximum  
2-1/2" ports are not allowed 90 degrees from any other port.  
See current product options on Attachment 2.

Serial No. End

Opposite End

## EXAMPLE

This example is provided to show you the proper way to specify your port locations. Please understand this example before filling out the ordering page. For questions concerning the use of this chart, please call the factory.

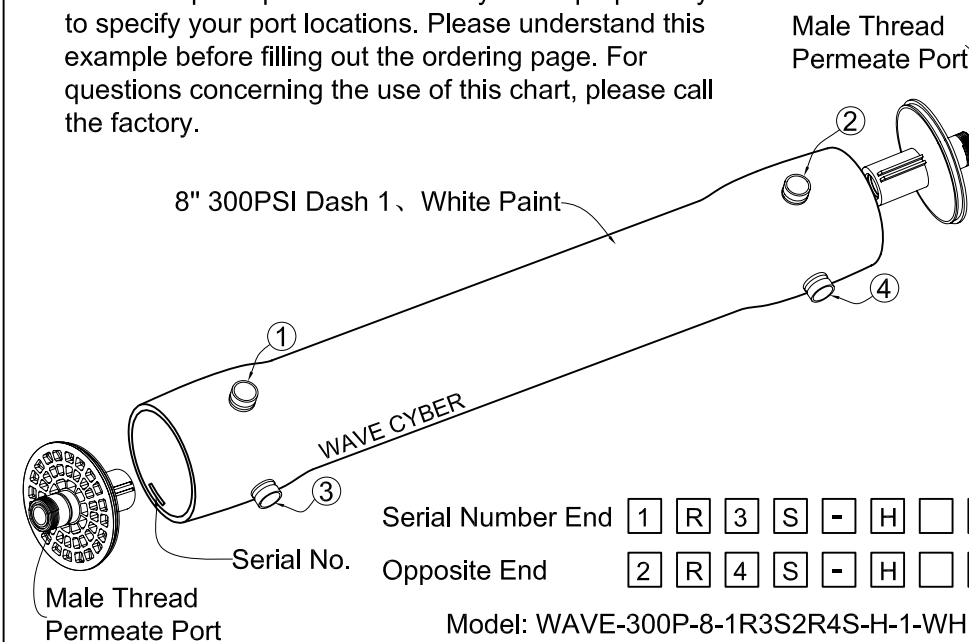

8" 300PSI Dash 1, White Paint

Serial Number End  1  R  3  S  -  H

Opposite End  2  R  4  S  -  H

Model: WAVE-300P-8-1R3S2R4S-H-1-WH

Permeate port thread type options:

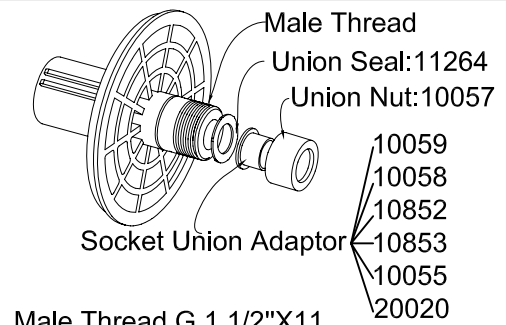

Male Thread G 1 1/2"X11

10059: Socket Union Adaptor, Code:H  
Fits a 32 mm O.D. Pipe;  
Material: PVC.

10058: Socket Union Adaptor, Code:J  
Fits a 1.32" O.D. Pipe;  
Material: PVC.

10852: Socket Union Adaptor, Code:F  
Female Thread NPT 1";  
Material: PVC.

10853: Socket Union Adaptor, Code:G  
Female Thread Rp 1";  
Material: PVC.

10055: Socket Union Adaptor, Code:V  
Mechanical Coupling 1"-ABS;  
Material: ABS.

20020: Socket Union Adaptor, Code:S  
Mechanical Coupling 1"-SS;  
Material: Stainless Steel.

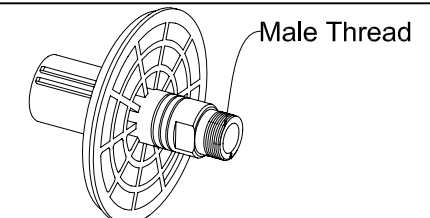

Male Thread NPT 1 1/4", Code: M

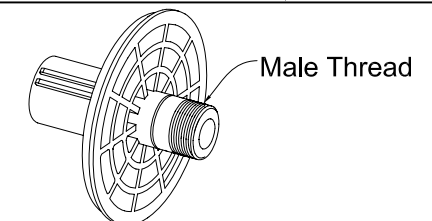

Male Thread NPT 1 1/2", Code: N

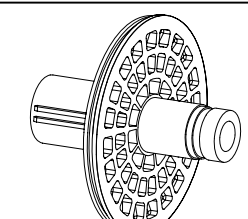

Mechanical Coupling 1.5", Code:UF

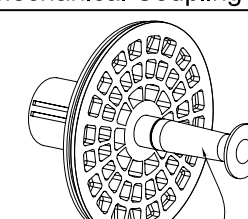

Sanitary Connection  1": 20440  
 1.5": 20603

20440: Sanitary Connection 1", Code:W  
Material: Stainless Steel.

20603: Sanitary Connection 1.5", Code:K  
Material: Stainless Steel.